

Nadir IP67 recessed floor luminaires

Installation Instructions

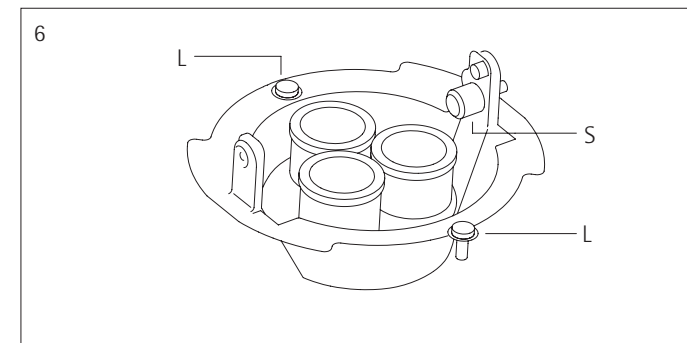
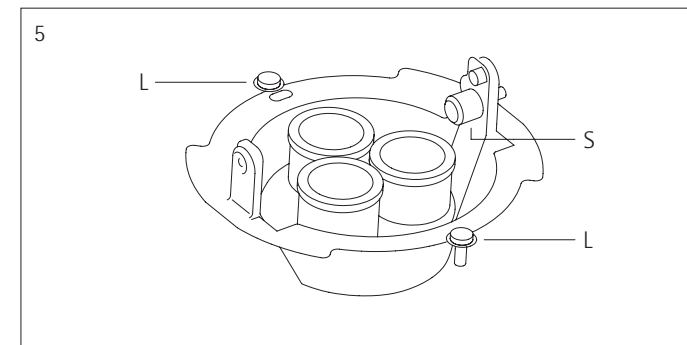
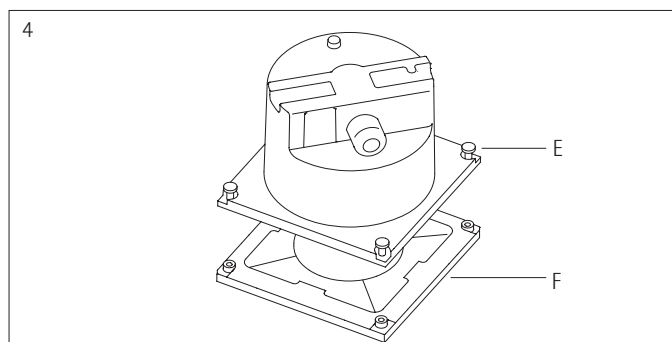
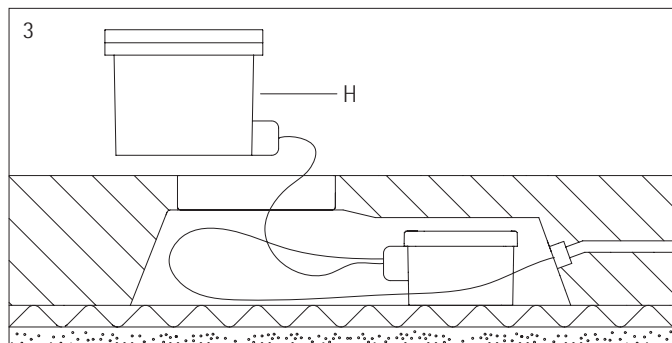
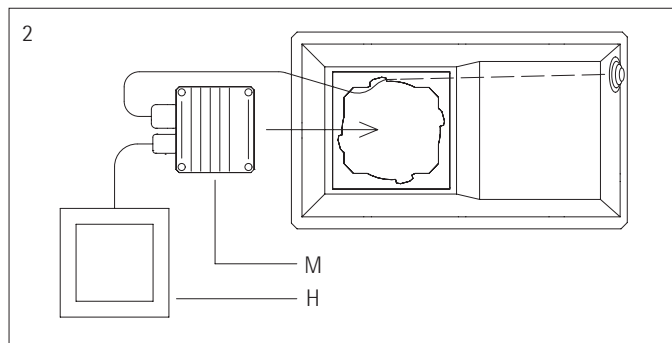
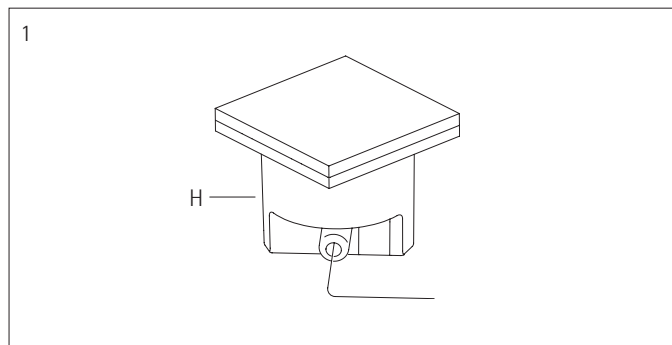

English

- Our continually updated product documentation can be accessed at www.erco.com/download.
- Please read these instructions carefully before installation and commissioning and hand over to the customer for retention.

General safety information

Warning! Risk of electric shock!
Before carrying out maintenance and installation on the luminaire, disconnect from the mains supply and ensure that all power is switched off.
- To avoid risks, if this luminaire has a damaged external flexible cable, it must only be replaced by the manufacturer, his service agent or qualified technician.
- When installing, always observe the national installation and accident prevention regulations.

Safety glass

Increased danger of slipping or skidding on glass when wet.
The luminaire must only be used complete with its protective shield.

Loading on the safety glass

The safety glass used can withstand a load of 5kN, if caused by people stepping onto the recessed floor luminaire. Loads caused by hard objects, by impacts or blows must always be avoided.

⚠, ☞☐ A damaged safety glass must be replaced.

Surface temperature of safety glass

Please note that the surface temperature will be raised by 30°C. Due consideration must be given to the surface temperature of the glass at the planning stage.

IP67

The luminaire is dust- and watertight. It is protected against the consequences of submersion. If there is a danger of flooding then suitable drainage must be provided.

Intended use

- Nadir recessed floor luminaires are only suitable for use in indoor areas.
- These luminaires are generally installed in separately pre-installed housings, mounting frames or mounting rings.

Choosing the mounting location

The luminaire must be positioned so as to avoid operation in direct sunlight or near other sources of heat. High ambient temperatures can reduce the life and efficiency of the control gear or LED module.

Electrical installation

To avoid any damage to the electronic control gear on a 3-circuit installation, the neutral conductor of electronic

control gear must never be interrupted.
Over-voltage protection
To protect electronic components from overload, e.g. when switching inductive loads, separate excess voltage protection devices can be used (e.g. ERCO 83819), connected in parallel on the input side.

Notes on corrosion protection

- In-ground luminaires must be installed such that water will drain away from the surface of the luminaire. When installing either in the ground directly or using an installation housing, additional drainage must be provided, viz. a bed of gravel.
- Ensure that the powder coating is not damaged during installation or maintenance work. Any damage, which becomes wet, can result in corrosion occurring. It is recommendable to use the luminaire in ground with a pH value of 5 to 8. In aggressive environments, the installation and maintenance of all parts will require appropriate protective measures. Chemicals damage the corrosion protection.

Mounting (Figs. 1-3)

1. Shorten the mains supply cable to be no more than 250mm in length from the top edge of the screed.

2. Make the electrical connection in an on-site connection box "M" (ERCO 33852).

The mains supply cable must be connected on-site in accordance with the required protection mode and protection class.

Notes: the electrical connection must be made in a suitable connection compartment.

The cable gland must not be opened.

3. Insert the connection box "M" into the installation housing, mounting frame or mounting ring (Figs. 2 & 3). The side without any cables must be inserted first into the mounting hole (see arrow).

4. Follow instructions in the "Setting the beam direction" section.

Setting the beam direction

1. Remove the luminaire using a suction cup (not supplied, ERCO 33799).

2. Undo screws "E" and remove safety glass "F" complete with the combined aperture mask (Fig. 4).

Note: secure the safety glass "F" to prevent it from falling down.

Directional luminaire (Fig. 5)

3. Release screws "L" (these adjust the rotation) and knurled screw "S" (adjusts the angle of tilt). Aim the luminaire as required and retighten all screws "L" and "S".

4. Re-close the housing with safety glass "F" and combined aperture mask. Evenly tighten the screws "E", ensuring the gasket is seated properly. Both the gasket and the surfaces to be sealed must be completely clean.

Note: replace any damaged gaskets.

5. Insert the luminaire "H" into the installation housing, mounting frame or mounting ring.

Notes:

Installation housing and mounting frame: ensure that the beam direction is correct. The luminaire can only be installed at rotational intervals of 90°.

Mounting ring: the luminaire can be additionally secured against twisting by securing the mounting ring with adhesive on site.

Grazing light wallwasher (Fig. 6)

3. Undo screws "L" (these adjust the range of rotation by +/- 5°) and knurled screw "S" (which set the angle of tilt). Aim the luminaire and retighten all screws "L" and "S".

4. Re-close the housing with safety glass "F" and combined aperture mask. Align the arrows on the housing and safety glass so that they are parallel. Evenly tighten the screws "E", ensuring that the gasket is seated properly. Both the gasket and the surfaces to be sealed must be completely clean.

Note: replace any damaged gaskets.

5. Insert the luminaire "H" into the installation housing, mounting frame or mounting ring.

Notes:

Installation housing and mounting frame: ensure that the beam direction is correct. The luminaire can only be installed at rotational intervals of 90°.

Mounting ring: the luminaire can be additionally secured against twisting by securing the mounting ring with adhesive on site.

Note

To remove the luminaire, use a suction cup (ERCO 33799).

Operating instructions for LED luminaires

In case of damage or a defective LED module, the entire luminaire must be returned to the factory.

Flashing of the LED module

It is normal for the LED module to flicker when switching on and off.

Cleaning

 Before cleaning, disconnect from mains supply and allow luminaire to cool!

- Regular cleaning is essential. The required intervals and methods depend on the mounting location, the mounting situation and the ambient conditions.

- Clean with a damp, soft cloth.

Cleaning the safety glass

Safety glass can be cleaned with cleaning agents that are also suitable for glass-ceramic cooking hobs.

Cleaning the collimating lenses and Spherolit lenses

Always use a soft cloth and a commer-

cially available, ph-neutral, alcohol-free, non-abrasive cleaning agent. The collimating lenses (secondary lenses) are fitted directly above the LEDs with their LED lenses (primary lenses). Like the Spherolit lenses (tertiary lenses), they are made of optical polymer and are sensitive to alcohol and abrasives.

Disposal

 In accordance with EU Directive WEEE (Waste Electrical and Electronic Equipment), luminaires must not be disposed of with other household waste. At the end of their life, luminaires must be taken to the appropriate local facility available for the disposal or recycling of electronic products.